

Programme

6th International Anthropological
Congress of Dr. Aleš Hrdlička

150th anniversary of birth

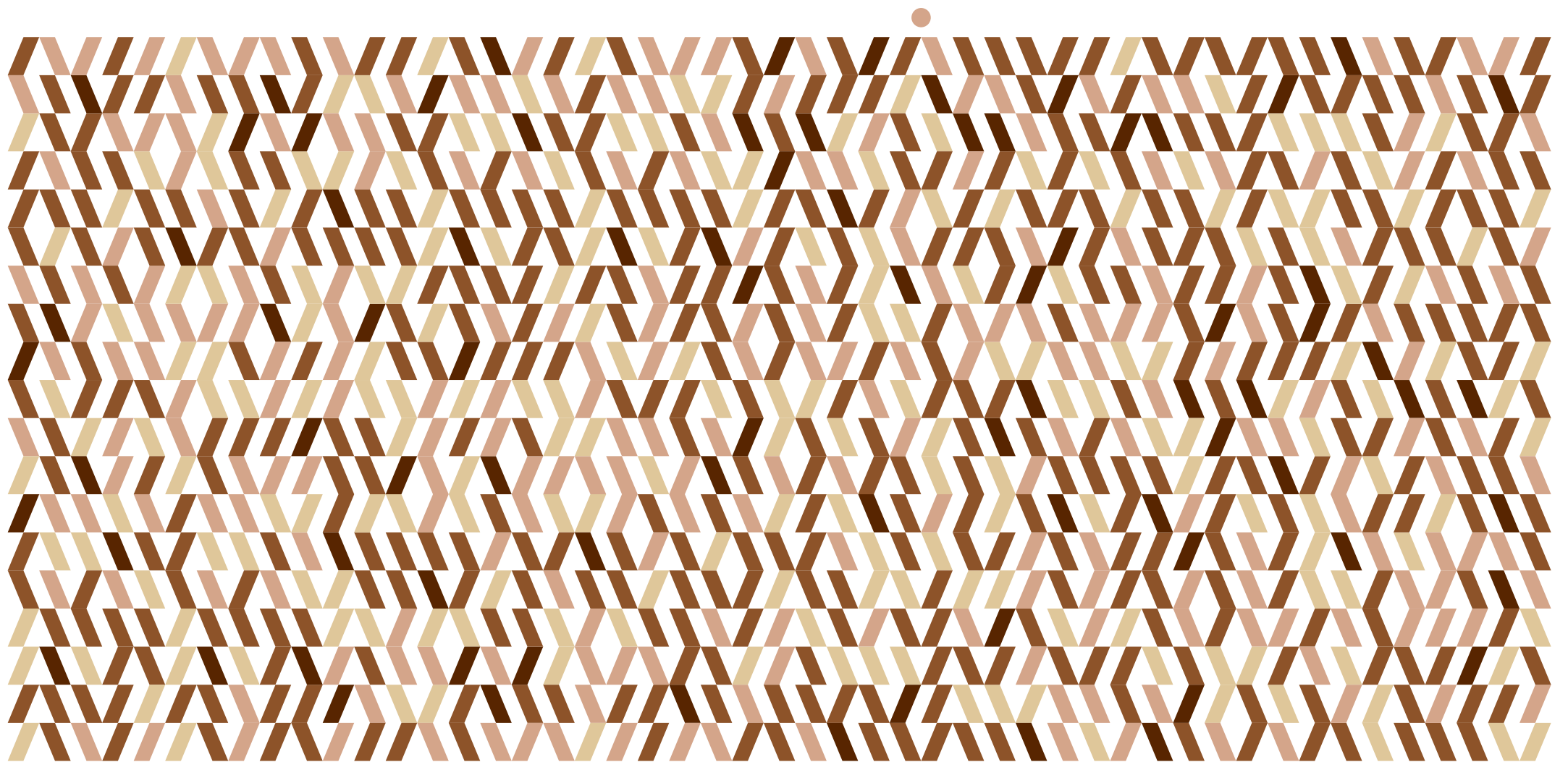

Organized by

The Czech Anthropological Society

Town Humpolec

A part of the congress is the 21st Prague-Lublin-Sydney-St. Petersburg Symposium

Organizing Committee

Honorary president of the Congress is

Pavel Bláha

Former long-time president of Czech Anthropological Society and member of Council of European Anthropological Association

Chair

Eva Drozdová, Masaryk University, Brno

Members

Pavel Bláha, Palestra, Prague

Kristýna Brzobohatá, Masaryk University, Brno

Martin Čuta, Masaryk University, Brno

Jiří Fiala, Municipality of Town Humpolec, Humpolec

Dana Fialová, Masaryk University, Brno

Ladislava Horáčková, Masaryk University, Brno

Kateřina Chmelíková, Ministry of Health, Prague

Miroslav Kopecký, Palacký University, Olomouc

Ivo Mařík, West Bohemia University, Pilsen

Michaela Račanská, Masaryk University, Brno

Andrej Shbat, Charles University, Prague

Lucie Stříbrná, University of Pardubice, Pardubice

Lenka Vargová, Masaryk University, Brno

Kateřina Vymazalová, Masaryk University, Brno

Honorary Committee

D. Barbieri — Italy

R. Beňuš — Slovak Republic

B. Bogin — United Kingdom

J. Buikstra — United States of America

M. Dudin — Russian Federation

M. Hermanussen — Germany

J. Hyánek — Czech Republic

R. Jankauskas — Lithuania

M. Janura — Czech Republic

M. Kaczmarek — Poland

T. Karski — Poland

A. Kukrechtová — Czech Republic (Humpolec)

G. P. Lyritis — Greece

J. Pařízková — Czech Republic

C. Povýšil — Czech Republic

F. Rühli — Switzerland

T. Slawinska-Ochla — Poland

Š. Svačina — Czech Republic

E. V. Veselovskaya — Russian Federation

Invited Speakers

J. E. Buikstra (Arizona State University, United States of America)

M. Kaczmarek (Adam Mickiewicz University, Poland)

E. V. Veselovskaya (Russian Academy of Science, Russian Federation)

I. Mařík (West Bohemia University Pilsen, Czech Republic)

C. Povýšil (Charles University Prague, Czech Republic)

Patronage

The U.S. Embassy in the Czech Republic

Milan Štěch, Vice-President of the Senate of the Parliament of the Czech Republic

Karel Kratochvíl, Mayor of Town Humpolec

Rector of Masaryk University Brno

Rector of Palacký University Olomouc

Rector of Pardubice University

Rector of Charles University Prague

Dean of Faculty of Science Masaryk University Brno

Dean of Faculty of Health Sciences

Palacký University Olomouc

Dean of Faculty of Physical Culture

Palacký University Olomouc

Dean of Faculty of Chemical Technology

Pardubice University

Dean of 1st Faculty of Medicine

Charles University Prague

Czech Medical Association J. E. Purkyně

Programme of the congress

TUESDAY, SEPTEMBER 3, 2019

8.30–11.00 – Registration of participants (Cinema Hall)

11.00–11.30 – Opening ceremony

11.30–13.00 – Plenary session

13.00–14.30 – Lunch

14.30–15.45 – Sessions, symposium (Fabrika Hotel)

Session 1 Mahler room

Dr. Aleš Hrdlička, Sociocultural anthropology

Session 2 Malý Hliník room

Auxology

Session 3 Orlík room

Opening of the 21st Prague - Lublin - Sydney - St. Petersburg Symposium

15.30–16.00 – Coffee break

16.00–17.30 – Sessions, symposium, poster discussion
1st part (Fabrika Hotel)

Session 4 Orlík room

21st Symposium: Biomechanics –
functional adaptation of human locomotor system

Session 5 Mahler and Malý Hliník rooms

Poster discussion 1st part (posters No. 1–17)

Exhibition of posters: **Tuesday, September 3,
8.30 till Wednesday, September 4, 13.30**

18.00–19.00 – Sightseeing of Humpolec

20.00 – Organ concert in St. Nicolas Church completed of
appearance of band “Ars Camerata”

WEDNESDAY, SEPTEMBER 4, 2019

9.00–10.00 – Plenary session (Cinema Hall)

10.00–10.30 – Coffee break

10.30–12.00 – Sessions, symposium (Fabrika Hotel)

Session 6 Mahler room

Anthropogenetics

Session 7 Malý Hliník room

Palaeopathology

Session 8 Orlík room

21st Symposium: Patho-biomechanics diagnostics –
orthopaedic prosthetics

11.45–12.15 – Coffee break

12.15–13.30 – Sessions, symposium (Fabrika Hotel)

Session 9 Mahler room

Palaeoanthropology and varia

Session 10 Malý Hliník room

Clinical anthropology

Session 11 Orlík room

21st Symposium: Biomechanics – bone diseases – diagnosis

13.30–14.00 – Lunch

14.00–16.30 – Tours to Želiv monastery and to Lipnice castle

16.30–18.00 – Concert of Band of the Castle Guards and the
Police of the Czech Republic

19.00–20.00 – Awarding Hrdlička's memorial medals – with
performance of saxophone band “Swinging Chipses”

20.00 – Casual Congress Dinner with musical accompaniment
of local bands “Radovanka” and “Hudba Dvořák”

THURSDAY, SEPTEMBER 5, 2019

9.00–10.00 – Plenary session (Cinema Hall)

10.00–10.30 – Coffee break

10.30–12.00 – Sessions, symposium, poster discussion
2nd part (Fabrika Hotel)

Session 12 Mahler and Malý Hliník rooms

Poster discussion 2nd part (posters No. 18–30)

Exhibition of posters: **Wednesday, September 4,
13.30 till Thursday, September 5, 15.00**

Session 13 Orlík room

21st Symposium: Osteology – bone diseases – diagnosis –
comprehensive treatment

12.00–13.00 – Lunch

13.00–15.00 – Sessions, symposium (Fabrika Hotel)

Session 14 Mahler room

Forensic anthropology and war anthropology

Session 15 Malý Hliník room

Historical anthropology

Session 16 Orlík room

21st Symposium: Disorders of growing skeleton

15.30 – Official closing of the Congress (Cinema Hall)

General information

Congress venue

The 6th International Anthropological Congress of Dr. Aleš Hrdlička takes place from September 3 to September 5, 2019 in Humpolec, the home town of Dr. Aleš Hrdlička

The congress venue is the Fabrika Hotel (Školní ulice 551 – School Street 551) and the Cinema Hall in Humpolec (Havlíčkovo náměstí 91 – Havlíček Square 91). Both buildings are situated at opposite sides of a little square

Language

The official language of the congress is English. No simultaneous translation will be provided

The registration

A registration desk will be opened in the Cinema Hall on the first day of the congress (September 3, 2019) and then all days of the congress as follows:

September 3, 2019 (Tuesday)

8.30—13.00 at Cinema Hall

14.00—18.00 at Fabrika Hotel

September 4, 2019 (Wednesday)

8.30—14.00 at Fabrika Hotel

September 5, 2019 (Thursday)

8.30—15.00 at Fabrika Hotel

Registration fees

Participants	120 €
Participants – reduced rate	100 €
Students	80 €
Accompanying persons	80 €

The members of Honorary Committee take part in the Congress free of charge

The reduced rate is for members:

Czech Anthropological Society

Slovak Anthropological Society

Society for Connective Tissues

Czech Medical Association /CMA/ J.E. Purkyně

Society for Prosthetics and Orthotics CMA J.E. Purkyně

Participants from University of Vincent Pol and Medical University in Lublin, Poland

Children's Rehabilitation Centre of Orthopaedics and

Traumatology "Ogonyok", St. Petersburg, Russia

The registration fee includes: refreshments served up during coffee breaks, common dinner, organ concert, admittance of the Museum of Dr. Aleš Hrdlička, promenade concert on Upper Square, Memorable Medal Awards as well as awards for the winners of Dr. Hrdlička's Competition for Ph.D. theses

Lunches are not included in the fee

Certificate of attendance will receive every participant during registration

All further information will participants receive at registration desk or at web pages of the congress www.iacah.eu in section Last news

Persons at registration desk are ready to help participants with all their problems

Presentation of papers

The allocated time for an oral presentation is 15 minutes, questions included. Keeping the time limits will be strictly observed to prevent the delays in a scientific programme

It is advisable to save the presentation in PC before the sessions to eliminate any possible technical problems. The recommended formats are ppt, pptx and pdf

Standard equipment of each lecture room is PC, data projector and laser pointer. Special demand for the presentation should be declared at the registration

Posters

The poster sessions will be held in lecture rooms of Fabrika Hotel (Mahler and Malý Hliník) where are situated special walls for fixing posters. Special fixing material, obtain participants at registration desk

Poster dimensions are: width 841 mm, length 1189 mm (format A0)

Font is min. 24 Arial. Text must be legible within the distance of 2 meters

The author or co-author of the poster must be present by the poster during poster session

The printing expenses of the poster are on the author

Social programme

Free admittance to the expositions of Museum of Dr. Aleš Hrdlička in Humpolec will be available for all participants during the Congress (Museum of Dr. Aleš Hrdlička, Horní náměstí 273 – Upper Square 273, Humpolec)

September 3, 2019

18.00–19.00

Sightseeing of Humpolec – in footsteps of Aleš Hrdlička (comment will be translated into English)

The participants will meet up in front of Fabrika Hotel. Attendant is Dr. Pavel Holub from County Archive in town Pelhřimov

20.00–

St. Nicholas Church (Horní náměstí – Upper Square, Humpolec) An organ concert, followed by the performance of Humpolec historic music group “Ars Camerata”

September 4, 2019

14.00–17.00

Collective tours to:

Želiv monastery or Lipnice castle

Price: 10 €

16.30–18.00

Concert of Band of the Castle Guards and the Police of the Czech Republic at “Horní náměstí” in Humpolec (Upper Square in Humpolec)

19.00–20.00

Awarding Dr. Hrdlička's Memorial Medals and announcement of final results of the Price of Dr. Hrdlička for theses in Ph.D. category – with performance of saxophone band “Swinging Chipses” (Cinema Hall in Humpolec)

20.00–

Casual Congress Dinner with musical accompaniment of local bands “Radovanka” and “Hudba Dvořák”

(Spolkový dům – Communal House in Humpolec, Soukenická Street)

Plenary sessions

September 3, 2019 11.30—13.00, Cinema Hall

11.30–12.30

Jane E. Buikstra (Arizona State University, United States of America)

“... a pyramid that stands on its point “– Ales (Alois) Hrdlicka's vision of research in physical anthropology

12.30–13.00

Pavel Bláha (Palestra, Prague)

History of congresses of Dr. Aleš Hrdlička

September 4, 2019 9.00—10.00, Cinema Hall

9.00–9.30

Maria Kaczmarek (Adam Mickiewicz University, Poland)

Female reproductive potential throughout the lifespan: an anthropological perspective

9.30–10.00

Elizaveta V. Veselovskaya (Russian Academy of Science, Russian Federation)

Russian school of anthropological reconstruction. Achievements and projects

September 5, 2019 9.00—10.00, Cinema Hall

9.00–9.30

Ivo Mařík, Daniela Zemková, Alena Maříková, Šárka Petrášová, Radek Myslivec, Olga Hudáková, Miroslav Petrtyl,

Ctibor Povýšil, Josef Hyánek, Miroslav Kuklík, Kazimierz Kozłowski (West Bohemia University Pilsen, Centre for Defects of Locomotor Apparatus Prague, University Hospital Motol Prague, Hospital Píbram, Czech Technical University Prague, Charles University and General Faculty Hospital Prague, Hospital Homolka Prague, Endocrinologic Institute Prague, Czech Republic, Children's Hospital at Westmead, Sydney, Australia)

Orthopaedic anthropology

Microscopical principles for differentiation of diagenetic and pathological intra vitam changes of archaeological bone

Orthopaedic anthropology

9.30–10.00

Ctibor Povýšil, Václav Smrčka (Charles University Prague, Czech Republic)

Microscopical principles for differentiation of diagenetic and pathological intra vitam changes of archaeological bone

Programme of the
6th International
Anthropological Congress
of Dr. Aleš Hrdlička

TUESDAY, SEPTEMBER 3, 2019

Cinema Hall

8.30—11.00 – Registration of participants

11.00—11.30 – Opening ceremony

11.30—12.30 – *Jane E. Buikstra (Arizona State University, United States of America)*

“... a pyramid that stands on its point “– Ales (Alois) Hrdlicka’s vision of research in physical anthropology

12.30—13.00 – *Pavel Bláha (Palestra, Prague)*

History of congresses of Dr. Aleš Hrdlička

13.00—14.30 – Lunch

14.30—15.30 – Session 1:
Dr. Aleš Hrdlička, Sociocultural anthropology

Room: Fabrika Hotel – Mahler

14.30—14.45 – *Budil I. T.*

Aleš Hrdlička and racial anthropology

14.45—15.00 – *Maiello G.*

Giustiniano Nicolucci, an influential but forgotten pioneer of Anthropological studies

15.00—15.15 – *Anggawi S. M.*

The art of activism on Bali, Indonesia

15.15—15.30 – *Valnoha J.*

Research on social behavior during nightlife and entertainment in urban areas

14.30—15.45 – Session 2:
Auxology

Room: Fabrika Hotel – Malý Hliník

14.30—14.45 – *Kutáč P., Krajcigr M.*

The application of typical error of measurement in the assessment of body composition measurement accuracy using the DXA method

14.45—15.00 – *Musálek M., Pařízková J., Kokštejn J., Godina E., Bondareva E.*

Normal weight obesity in preschool and middle-school-aged children

15.00—15.15 – *Novák J., Brůžek J., Sedlak P.*

Male obesity during adolescence, a feminine skeleton in adulthood? Longitudinal monitoring of obese individuals

15.15—15.30 – *Regecová V., Hamade J., Ševčíková L., Janechová H., Neščáková E., Beňuš R., Masnicová S.*

Secular trends in body characteristics among Slovak students and adolescents during three decades

15.30—15.45 – *Konečná H.*

“All mankind is of one origin” in the context of modern reproductive technologies

14.30—15.30 – Session 3:
Opening of the 21st Prague - Lublin - Sydney - St. Petersburg Symposium

Main topic: ORTHOPAEDIC ANTHROPOLOGY:
Interdisciplinary approach to growing skeleton

Room: Fabrika Hotel – Orlík

Welcome Speeches

Professor Ivo Mařík, M.D., Ph.D.

President of the Society for Connective Tissues Czech Medical Association (CMA) J.E. Purkyně

Professor Mikhail Dudin, M.D., DSc.

Honorary member of the Society for Connective Tissues, CMA J.E. Purkyně

Professor Tomasz Karski, M.D, Ph.D.

Honorary member of the Society for Connective Tissues, CMA J.E. Purkyně)

Professor Josef Hyánek, M.D., DSc.

Honorary president of the Society for Connective Tissues CMA J.E. Purkyně

15.30—16.00 – Coffee break

15.45—16.00 – Coffee break

16.00—17.30 – Session 5:
Poster discussion 1st part (posters No. 1—7)

Rooms: Fabrika Hotel – Mahler

Posters will be exhibited from Tuesday, September 3,
8.30 till Wednesday, September 4, 13.30

Tuesday, September 3, 2019

1. Aidonis A., Papageorgopoulou Ch.

Skull surgery in ancient Greece: New cases of trepanation from
Classical-Hellenistic times

2. Gkaniatsou E., Vika E., Papageorgopoulou Ch.

Breastfeeding and weaning patterns in ancient Thessaloniki

3. Kostrhun P.

Aleš Hrdlička and American archaeologists and anthropolo-
gists in Moravia between the two world wars

**4. Novotná K., Fialová D., Chochořová E., Drozdová E.,
Brzobohatá K., Klíma B.**

Ancient DNA mining from chemically treated and non-treated
human dental calculus

5. Půtová L., Smrčka V., Trubač J.

Diet reconstruction in High Middle Ages to Early Modern
Period population

6. Rasskazova A., Khokhlov A., Safarova I.

Craniofacial identification of high church hierarch buried in the
Transfiguration Cathedral in Tver

**7. Teschler-Nicola M., Mandl K., Becker S., Stelzer S.,
Pahr D., Weiss-Krejci E.**

A “perforated” human hyoid bone: bone artefact or thyroglos-
sal duct cyst?

18.00—19.00 – Sightseeing of Humpolec

20.00 – Organ concert in St. Nicolas Church completed of
appearance of band “Ars Camerata”

16.00—17.30 – Session 5:
Poster discussion 1st part (posters No. 8—17)

Rooms: Fabrika Hotel – Malý Hliník

Posters will be exhibited from Tuesday, September 3,
8.30 till Wednesday, September 4, 13.30

Tuesday, September 3, 2019

8. Seifert Z., Shbat A., Klepáček I.

Virtual projection of 2D basic facial features onto a 3D model

**9. Vymazalová K., Vargová L., Horáčková L., Račanská M.,
Jarošová I., Trampota F., Kala J.**

Occurrence of scurvy in the Czech Lands at various historical
periods

10. Vytlačil Z., Drtíková Kaupová S., Poláček L., Velemínský P.

Residential mobility in Great Moravia investigated using
strontium isotope analysis

11. Annar D., Feher P., Zsakai A., Muzsnai A., Bodzsar E.

Turner-syndrome patients' body structural characteristics

**12. Asienkiewicz R., Nowacka-Chiari E., Biczysko G.,
Skorupka E.**

Changes in physical development and motor fitness of stu-
dents studying at the University of Zielona Góra (1990-2015)

13. Asienkiewicz R., Tatarczuk J., Wandycz A.

The secular trend in the height and weight of boys and girls
residing in Lubusz Region (2002-2017)

**14. Chaplinskaya E. V., Sakhno I. P., Mezen N. I., Korbut Y. I.,
Hryharovich V. V.**

Comparative characteristics of biological indicators of students
from different countries of the world

15. Feher P., Annar D., Zsakai A., Bodzsar E.

Quantitative ultrasound densitometrical and body structural
parameters in screening of bone structural abnormalities in
women

16. Hrušková M., Landauerová M., Čermáková S.

The influence of training on the physical characteristics of
adolescent swimmers and hockey players

17. Hrušková M., Mráčková P., Bublíková, V.

Tests of motoric performance and physical fitness in Czech
professional and voluntary firefighters

14.30—15.30 – Session 3:
Opening of the 21st Prague - Lublin - Sydney -
St. Petersburg Symposium

Anniversary of Professor Tomasz Karski, M.D., Ph.D.

Introduction: *Olga Hudáková, M.D., Ph.D.*

Moderator: *Professor Josef Hyánek, M.D., DSc. (Honorary
president of the Society for Connective Tissues, Czech Medical
Association J.E. Purkyně)*

14.30—14.50 – *Karski T., Karski J., Domagala M.*

Syndrome of standing 'at ease' on the right leg as an important
factor in the development of the so-called adolescent idiopath-
ic scoliosis (AIS) and an influencing factor in the pathology of
right shank, knee, hip and back pain

Anniversary of Prof. Mikhail Dudin, M.D., DSc

Introduction: *Olga Hudáková, M.D., Ph.D.*

Moderator: *Professor Ivo Mařík, M.D., Ph.D. (President of the
Society for Connective Tissues, Czech Medical Association
J.E. Purkyně)*

14.50—15.10 – *Dudin M., Pinchuk D., Pankratova G.*

Interdisciplinary collaboration in the study of the children's
musculoskeletal system: facts, reflections, conclusions

15.10—15.30 – Family photo of participants

15.30—16.00 – Coffee break

16.00—17.20 – Session 4:
Biomechanics – functional adaptation of human
locomotor system

Room: Fabrika Hotel – Orlík

16.00—16.20 – *Pařízková J., Sedlak P., Musálek M.*

The impact of adaptation to hypokinesia during early growth

16.20—16.40 – *Kott O., Vrbská V.*

Sedentary work – The importance of adopting and maintaining
correct sitting posture. Knowledge translation

16.40—17.00 – *Karski T., Karski J., Domagala M., Słowińska B.,
Boryga B., Pyrc J.*

Improper sitting position in Children, Adolescents and Adults.
Causes. Clinic. Physiotherapy

17.00—17.20 – *Van Loon P. J. M., Soeterbroek A. M., Grotenhuis A.*
Homo Erectus and backpain? Being Homo Sedens from birth
is an unhealthy evolution!

WEDNESDAY, SEPTEMBER 4, 2019

Cinema Hall

9.00—9.30 – *Maria Kaczmarek (Adam Mickiewicz University, Poland)*

Female reproductive potential throughout the lifespan: an anthropological perspective

9.30—10.00 – *Elizaveta V. Veselovskaya (Russian Academy of Science, Russian Federation)*

Russian school of anthropological reconstruction. Achievements and projects

10.00—10.30 – Coffee break

10.30—11.45 – Session 6:
Anthropogenetics

Room: Fabrika Hotel – Mahler

10.30—10.45 – *Chocholová E., Drozdová E., Fialová D., Brzobohatá K., Chochola V.*

Need for novel detection targets in tuberculosis diagnostics of historical specimens – bioinformatic analysis

10.45—11.00 – *Chocholová E., Fialová D., Drozdová E., Skoupý R., Brzobohatá K., Zwinsová B., Vídeňská P., Chochola V.*

Microbial contamination of ancient human dental calculus studied by scanning electron microscopy and metagenomic approach

11.00—11.15 – *Fialová D., Chocholová E., Drozdová E., Brzobohatá K., Zwinsová B., Vídeňská P., Chochola V., Klíma B.*
Study of domestication via human dental calculus in the Early Middle Ages

11.15—11.30 – *Šenovská A., Drozdová E., Vaculík O., Brzobohatá B., Fialová D., Šmerda J.*

Mitochondrial haplogroups of ancient samples from Czech Republic: Comparison of two nearby located burial Sites

11.30—11.45 – *Brzobohatá K., Bus M., Lembring M., Hocker F., Allen M.*

Genetic analysis of individuals from Vasa ship

11.45—12.15 – Coffee break

10.30—11.45 – Session 7:
Palaeopathology

Room: Fabrika Hotel – Malý Hliník

10.30—10.45 – *Smrčka V.*

Biomolecular paleopathology from my point of view

10.45—11.00 – *Smrčka V.*

Czech paleopathology, past and future

11.00—11.15 – *Jakobej L.*

Reconstruction of war injuries on selected skull preparations from the ossuary in Žehuň

11.15—11.30 – *Tvrđý Z., Jarošová I.*

Anthropology, health and diet of Eneolithic and Bronze Age populations from Modřice (Czech Republic)

11.30 – 11.45 – *Vlach M.*

Antonine Plague: The case study of epidemiological modelling and impact evaluation

11.45—12.15 – Coffee break

10.30—12.00 – Session 8:
Patho - biomechanics - diagnostics - orthopaedic prosthetics

Room: Fabrika Hotel – Orlík

10.30—10.50 – *Arsenev A., Dudin M.*

Cuneiform vertebral deformation in patients with AIS

10.50—11.10 – *Krawczyk P.*

Possibilities of orthotic treatment in children with cerebral palsy

11.10—11.25 – *Pankratova G., Dudin M.*

Evaluation of the brace treatment effectiveness in patients with progressive scoliosis

11.25—11.40 – *Černý P., Drnková J., Kott O., Negrini S.*

Design of spinal brace shape classification

11.40—12.00 – *Arsenev A., Vasilevich S., Dudin M., Falinskii A.*

Prospects of application of 3D scanner in terms of children's orthopedic center

12.00—12.15 – Coffee break

12.15—13.30 – Session 9:
Palaeoanthropology and varia

Room: Fabrika Hotel – Mahler

12.15—12.30 – *Nowaczewska W., Binkowski M.*

The taxonomic assessment of new hominin molar and premolar from Stajnia Cave (Poland)

12.30—12.45 – *Petr M., Pääbo S., Kelso J., Vernot B.*

Limits of long-term selection against Neanderthal introgression

12.45—13.00 – *Petr M., Hajdinjak M., Fu Q., Essel E., Golovanova L. V., Doronichev V. B., Shunkov M. V., Derevianko A. P., Rougier H., Crevecoeur I., Semal P., Lalueza-Fox C., Rasilla M., Rosas A., Meyer M., Vernot B., Pääbo S., Kelso J.*

The evolutionary history of Denisovan and Neanderthal Y chromosomes

13.00—13.15 – *Vasilyev S., Borutskaya S. B., Galeev R. M., Yatsishina E. B., Kovalchuk M. V., Ushakov V. L.*

Application of computed tomography in anthropological study of ancient Egyptian mummies

13.15—13.30 – *Jančová M., Štelcl J., Klíma B. F., Drozdová E.*

Analysis of chemical elements on surface enamel and localised enamel hypoplasia of human primary canines (LHPC) via EDX method in the Necropolis of Great Moravia in Znojmo-Hradiště (9th-10th Century, Czech Republic)

12.15—13.30 – Session 10:
Clinical anthropology

Room: Fabrika Hotel – Malý Hliník

12.15—12.30 – *Gimunová M., Vodička T., Sebera M., Kalichová M., Skotáková A., Hedbávný P., Jánský K., Kolářová K.*

Do the sport dance, classical ballet and Slovakian folklore dance training affect the gait stereotype?

12.30—12.45 – *Hrušková M., Ťoupalová L., Vašková I., Rejtharová D.*

The physical characteristics of preschoolchildren and schoolchildren in relation to the type of nutrition in infancy

12.45—13.00 – *Koziel S., Gomula A., Nowak-Szczepanska N.*
Maternal stress during pregnancy and its effect on postnatal growth in school children

13.00—13.15 – *Marfina V.*

Dynamic observation of physical development indices of schoolchildren in the Republic of Belarus

13.15—13.30 – *Kláštěrecká R., Chrastina J., Vaňharová M.*
Health benefits of Yoga: a scooping review

12.15—13.35 – Session 11:
Biomechanics - bone diseases - diagnosis

Room: Fabrika Hotel – Orlík

12.15—12.35 – *Vasilevich S., Arsenev A., Kurchenko S., Dudin M., Falinskii A.*

Piezoelectric effect in bone during extracorporeal shock wave therapy in experiment

12.35—12.55 – *Pankratova G., Dudin M.*

Functional violations of urinary system in children with idiopathic scoliosis

12.55—13.15 – *Khaymina T., Avaliani T., Karpenko M., Dudin M., Pinchuk D.*

Features of endogenous neuropeptides in children with initial symptoms of AIS

E – poster

13.15—13.25 – *Rybka D., Dudin M., Sharova L.*

Ultrasound diagnosis of paravertebral muscles in children with AIS before and after treatment

E – poster

13.23—13.35 – *Bober S. S., Dudin M., Uzdennikova M.*

Characteristics of the spatial orientation of the vertebral column, shoulder and pelvic girdle in patients 7-17 years of age with initial symptoms of scoliosis

14.00—16.30 – Tours to Želiv monastery and Lipnice castle

16.30—18.00 – Concert of Band of the Castle Guards and the Police of the Czech Republic

19.00—20.00 – Awarding Hrdlička's medals – with performance of saxophone band "Swinging Chipses"

20.00 – Casual Congress Dinner with musical accompaniment of local bands "Radovanka" and "Hudba Dvořák"

THURSDAY, SEPTEMBER 5, 2019

Cinema Hall

9.00—9.30 – Ivo Mařík, Daniela Zemková, Alena Maříková, Šárka Petrášová, Radek Myslivec, Olga Hudáková, Miroslav Petrtýl, Ctibor Povýšil, Josef Hyánek, Miroslav Kuklík, Kazimierz Kozłowski (West Bohemia University Pilsen, Centre for Defects of Locomotor Apparatus Prague, University Hospital Motol Prague, Hospital Pribram, Czech Technical University Prague, Charles University and General Faculty Hospital Prague, Hospital Homolka Prague, Endocrinologic Institute Prague, Czech Republic, Children's Hospital at Westmead, Sydney, Australia)

Orthopaedic anthropology

9.30—10.00 – Ctibor Povýšil, Václav Smrčka (Charles University Prague, Czech Republic)

Microscopical principles for differentiation of diagenetic and pathological intra vitam changes of archaeological bone

10.00—10.30 – Coffee break

10.30—12.00 Session 12:
Poster discussion 2nd part (posters No. 18—23)

Rooms: Fabrika Hotel – Mahler

Posters will be exhibited from Wednesday, September 4, 13.30 till Thursday, September 5, 15.00
Thursday, September 5, 2019

18. Hurbo T., Salivon I.

Age variation of cephalic index according to schoolchildren transverse and longitudinal studies data

19. Kopecký M., Malinčíková J., Václavíková J., Kuchaříková M., Hrubá R., Pokorná J.

Monitoring of body composition in boys aged 12–15 and girls with obesity during a weight reduction stay in Lázně Teplice nad Bečvou, a.s.

20. Kopecký M., Stříbrná L., Hrubá R.

Sleep quality and sleep patterns in men and women in relation to body composition

21. Marčeková M., Neščáková E., Mellová Y.

The influence of nourishment on the somatic growth of children from birth to one year of life (The longitudinal study)

22. Polcerová L., Kondeková M., Králík M., Beňuš R.

Examination of population differences in radio-ulnar gradients on pilot samples of the Slovak and Czech population

23. Polina N.

The study of color preferences of belarusian students

12.00—13.00 – Lunch

10.30—12.00 – Session 12:
Poster discussion 2nd part (posters No. 24—30)

Rooms: Fabrika Hotel – Malý Hliník

Posters will be exhibited from Wednesday, September 4, 13.30 till Thursday, September 5, 15.00
Thursday, September 5, 2019

24. Přidalová M., Marešová K., Zbořilová V., Kalčíková P.

Somatic profil in young aged children

25. Přidalová M., Prášil D., Marek P.

Relation between BMI and morphological parameters of foot in young school-age children

26. Samešová D., Sedlak P., Novák J., Ondřejíková L., Pařízková J.

Secular changes in body composition and fat distribution in Czech preschool children

27. Skryhan H.

Influence of a complex of socio-economic factors on physical development of teenagers of Belarus

28. Škultétyová A., Koziel S. M., Králík M.

Inter-population variation in the metacarpophalangeal pattern profiles

29. Zbořilová V., Přidalová M., Kaplanová T.

Reference curves of selected circumferential parameters for Czech children aged 6 to 11 years

30. Kalčíková P.

Characteristics of elite youth soccer players by date of birth and biological maturity

12.00—13.00 – Lunch

10.30—12.00 – Session 13:
Osteology - bone diseases - diagnosis - comprehensive treatment

Room: Fabrika Hotel – Orlík

10.30—10.50 – Povýšil C.

Pathomorphology of crystal-associated osteoarthropathies in bioptic and archaeological materials

10.50—11.15 – Zemková D., Mařík I., Maříková A., Petrášová Š., Hudáková O.

Hypophosphatemic rickets: growth and body proportions in a group of Czech patients conventionally treated

11.15—11.40 – Mařík I., Zemková D., Maříková A., Myslivec R., Hudáková O., Kuklík M., Povýšil C.

The orthopaedic problems connected with vitamin D metabolism: Rickets, Osteomalacia, Hypophosphatemic rickets (X-linked hypophosphataemia)

11.40—12.00 – Vodička O.

Burosumab in the treatment of pediatric patients with XLH: results of recent clinical trials

12.00—13.00 – Lunch

13.00—14.00 - Session 14:
Forensic anthropology and anthropology in
response to natural disasters and wars

Room: Fabrika Hotel - Mahler

13.00—13.15 – *Jankauskas R.*

Anthropology as the meeting ground of several disciplines:
identification of remains of leaders of 1863-1864 uprising

13.15—13.30 – *Fialová D., Skoupý R., Drozdová E., Kováčik P.*

Application of SEM-EDX in forensic and historic anthropology
through dental fillings

13.30—13.45 – *Svobodová H.*

The difficulty of a forensic geneticist's work

13.45—14.00 – *Krošlák M.*

Wandering through Central Europe in the Middle Ages:
possible burial of an Outlander

13.00—14.45 - Session 15:
Historical anthropology

Room: Fabrika Hotel - Malý Hliník

13.00—13.15 – *Beran-Cimbůrková P.*

Anthropological analysis of skeletal remains found in a circular
object (middle bronze age) from Nymburk (Czech Republic)

13.15—13.30 – *Fojtová M.*

Extraordinary Great-Moravian graves from Staré Město in the
view of an anthropologist. A preliminary report

13.30—13.45 – *Hukelová Z.*

Life at Early Bronze Age site of Nižná Myšľa

13.45—14.00 – *Koukli M., Siegmund F., Papageorgopoulou Ch.*

Stature estimation on northern Greek populations of Roman
time

14.00—14.15 – *Pavelková J., Furmánek V.*

Demographic analysis of civilization of south-eastern urnfields
in Slovakia

14.15—14.30 – *Nováček J.*

Burials from the Merovingian aristocracy from Gotha
– Boilstädt

14.30—14.45 – *Scheelen-Nováček K., Nováček J., Bátora J.,
Kierdorf H., Schultz M.*

Evidence of interpersonal violence in the Early Bronze Age
cemetery of Ludanice - Mýtna Nová Ves

13.00—15.00 - Session 16:
Disorders of growing skeleton

Room: Fabrika Hotel - Orlík

13.00—13.20 – *Smrčka V., Dick D., Shahed S., Musilová Z.,
Köhler K., Tvrđý Z.*

Congenital Anomalies in Neolithic Lengyel Culture

13.20—13.40 – *Zemková D., Balaščíková M., Paprskářová M.,
Moslerová V., Mařík I.*

Pycnodysostosis in a Czech toddler, sclerosing bone dysplasia

13.40—14.00 – *Doktorová H., Hraběta J., Groh T.,
Abdel Rahman M., Feriančíková B., Černá T., Podhorská N.,
Eckschlager T.*

Neuroblastoma in musculoskeletal system, tumor hypoxia,
HIF-1 and chemoresistance

14.00—14.20 – *Ryba L., Rybová S., Nechutný J., Mařík I.*

Perthes' disease and femoroacetabular impingement in a
growing patient

14.20—14.40 – *Karski J., Okoński M., Ostrowski J.,
Matuszewski Ł., Kandzierski G., Karski T.*

50th Anniversary of Dega pelvic osteotomy in treatment of
DDH – dysplasia, subluxation or luxation of the hip joint

14.40—15.00 – *Van Loon P. J. M., Soeterbroe A. M.,
Grotenhuis A. H.*

Anthropology and the physical presentation of Homo sapiens
in the 21st century. Modern man and his posture

Ivo Mařík, Petr Krawczyk, Tomasz Karski, Mikhail Dudin

Closing of the Symposium and planning The 22nd Prague-
Lublin-Sydney-St. Petersburg Symposium

Cinema Hall

15.30 – Official closing of the Congress

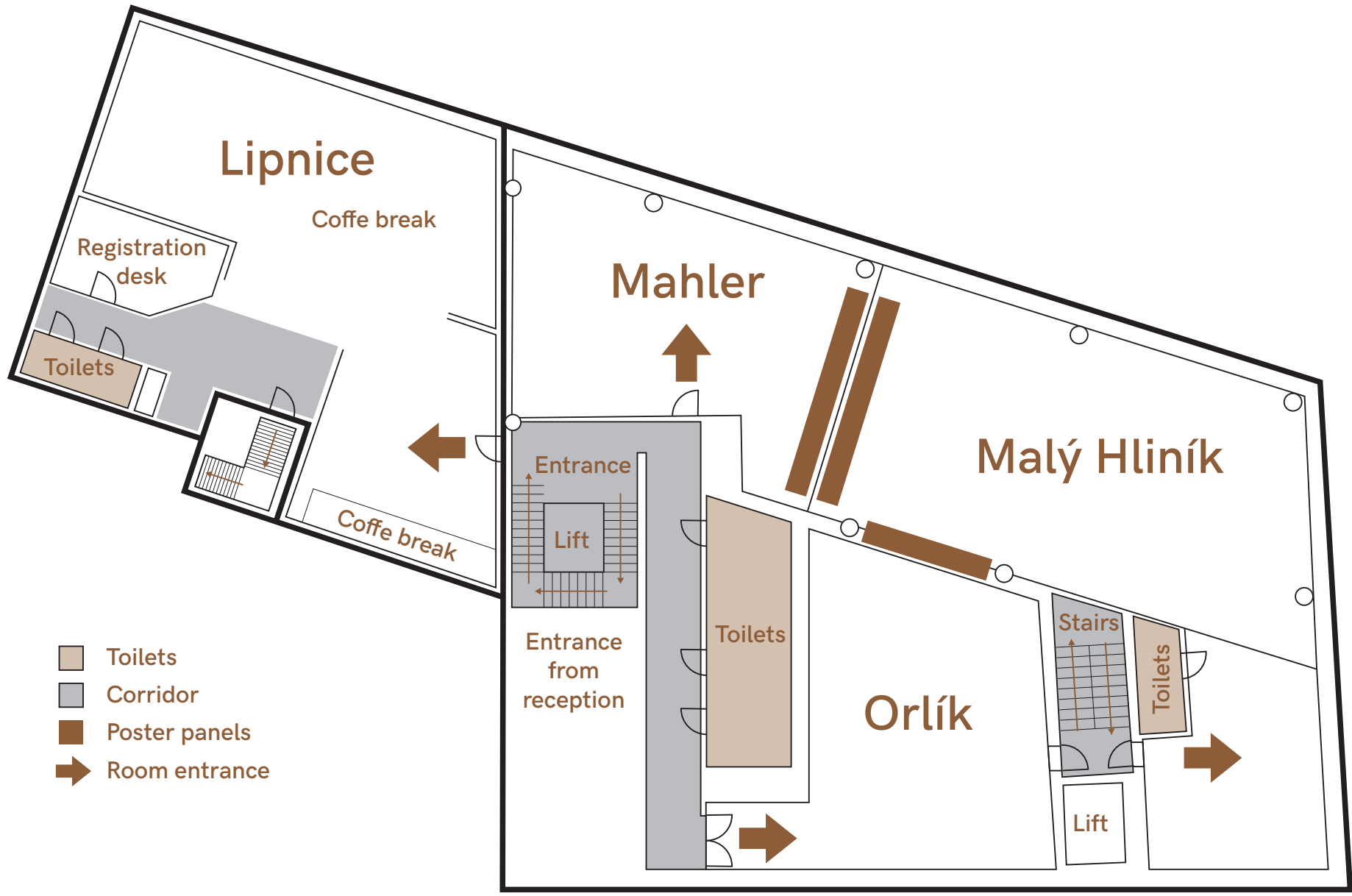

- Toilets
- Corridor
- Poster panels
- Room entrance

Entrance from restaurant

Some useful phrases and words for orientation in Czech milieu

Common Czech signs

Otevřeno	OPEN
Zavřeno	CLOSED
Vchod	ENTRANCE
Východ	EXIT
Tam	PUSH (on a door)
Sem	PULL (on a door)
Toalety/WC	TOILET
Muži/Páni	MEN
Ženy/Dámy	WOMEN
Vstup zakázán	ENTRANCE FORBIDDEN

Czech vocabulary (with pronunciation)

Yes	Ano (<i>AH-noh</i>)
No	Ne (<i>neh</i>)
Where	Kde (<i>KHDEH</i>)
What	Co (<i>TSOH</i>)
Who	Kdo (<i>GHDO</i>)
One	Jedna (<i>YEHD-nah</i>)
Two	Dvě (<i>dvveh</i>)
Three	Tři (<i>trzhee</i>)
Please	Prosím (<i>Proseem</i>)
Thank you	Děkuju (<i>Dyekooyih</i>)
I am sorry	Promiňte (<i>PROH-mih-nyteh</i>)
Pardon	Pardon (<i>par-DOHN</i>)
Hello (more polite)	Dobrý den (<i>DOH-bree dehn</i>)
Hello/Bye	Ahoj (<i>ahoy</i>)
Good bye	Na shledanou (<i>NAHSH-leh-dah-noh</i>)
I do not know	Nevím (<i>NEH-veem</i>)
Czech (language)	Česky (<i>cheskee</i>)

Shopping/Restaurant

How much is this?	Kolik to stojí? (KOH-lihk toh STOH-yee)
Czech crown	Česká koruna (cheskaa koh-ru-nah)
Can I pay by a credit card?	Můžu platit kartou? (MOO-zhuh PLAH-tiht KREH-diht-kow?)
Where is the restaurant?	Kde je restaurace? (gdeh yeh REHS-tow-rah-tse)
Coffe	Káva/kafe (KAHH-vah/KAH-feh)
Tea (drink)	Čaj (CHAHyeh)
Water	Voda (VOH-dah)
Beer	Pivo (PIH-voh)
Red/white wine	Červené/bílé víno (CHEHR-veh-nehh/ BEE-lehh VEE-noh)
Bon apetit	Dobrou chuť (DOH-broh khootch)
Cheers	Na zdraví (nah ZDRAH-vee!)

Useful Czech expressions

I can't speak Czech	Neumím mluvit česky (NEH-oomeem mloovit cheskee)
I understand	Rozumím (roh-zoo-meem)
I do not understand	Nerozumím (NEH-roh-zoo-meem)
Do you speak English?	Mluvíte anglicky? (Mlooveeteh unglitskee?)
Where is a bathroom?	Kde jsou toalety? (KHDEH ysoh toa-LEH-tihy?)
What is your name?	Jak se jmenujete? (yahk seh YMEH-noo-yete?)
My name is...	Jmenuji se.... (YMEH-noo-ee seh)
Nice to meet you	Těší mě (TYEH-shee myeh)
How are you?	Jak se máte? (yahk seh MAA-teh?)
I am fine, thank you	Dobře, děkuji (DOH-brzheh, DYEH-koo-yih)
What time?	V kolik hodin? (V-KOH-lihk HOH-dihn)

Emergency

Help	Pomoc (POH-mohts!)
Fire!	Hoří! (HOH-rzhee!)
Call a police	Zavolejte policii! (ZAH-voh-lay-teh POH-lih-tsee!)
Call 112	Zavolejte stodvanáct! (ZAH-voh-lay-teh stoh DVAH-naatst)
112	Czech Emergency number
I need your help	Potřebuji pomoc (POHT-rzheh-boo-yee POH-mots)
Thief	Zloděj (ZLOH-dye)
Accident	Nehoda (NEH-hoh-dah)
I am sick	Je mi špatně (yeh mee SHPAH-tnehh)
Stop	Stop/Stůj (stooyeh)
I need a doctor	Potřebuji doktora (POHT-rgeh-boo-yee DOHK-toh-rah)
It hurts	Bolí to (BOH-lee toh)

All mankind is
of one origin

